



F O R S A L E

On THE FAMED WOOD RIVER

1 Acre Lt 2 Bk 2 Nutaan - Attam Acres S/D

Great Located 1 acres Fee Simple River Front lot on the Famous Wood River. Access to Dillingham, Bristol Bay and entry into Lake Aleknagik and the Famed TIKCHIK Park and river system. Current access via river with future thoughts of road access from the recent construction of the bridge across the Wood River mouth with lake Aleknagik .

Asking Price of \$55,000.

see plat / map for location and dimensions

SURVEYOR AND THAT I HAVE COMPLETED THE SURVEY SHOWN HEREON. I DECLARE THAT THE DIMENSIONS, THE CORNERS, AND THE MONUMENTS SHOWN HEREON HAVE BEEN ESTABLISHED OR LOCATED TO THE BEST OF MY PROFESSIONAL KNOWLEDGE AND BELIEF.

Stanley E. Sears
 STANLEY E. SEARS, R.L.S. 2087-5

DATE 2/17/87



ID	NO.
1.60'	①
7.11'	②
3.77'	③
3.86'	④
2.72'	⑤
3.28'	⑥
1.35'	⑦
4.73'	⑧
5.26'	⑨
4.17'	⑩
1.95'	⑪
2.43'	⑫
3.38'	⑬
3.06'	⑭
7.03'	⑮
3.25'	⑯
3.14'	⑰
7.87'	⑱
3.27'	⑲

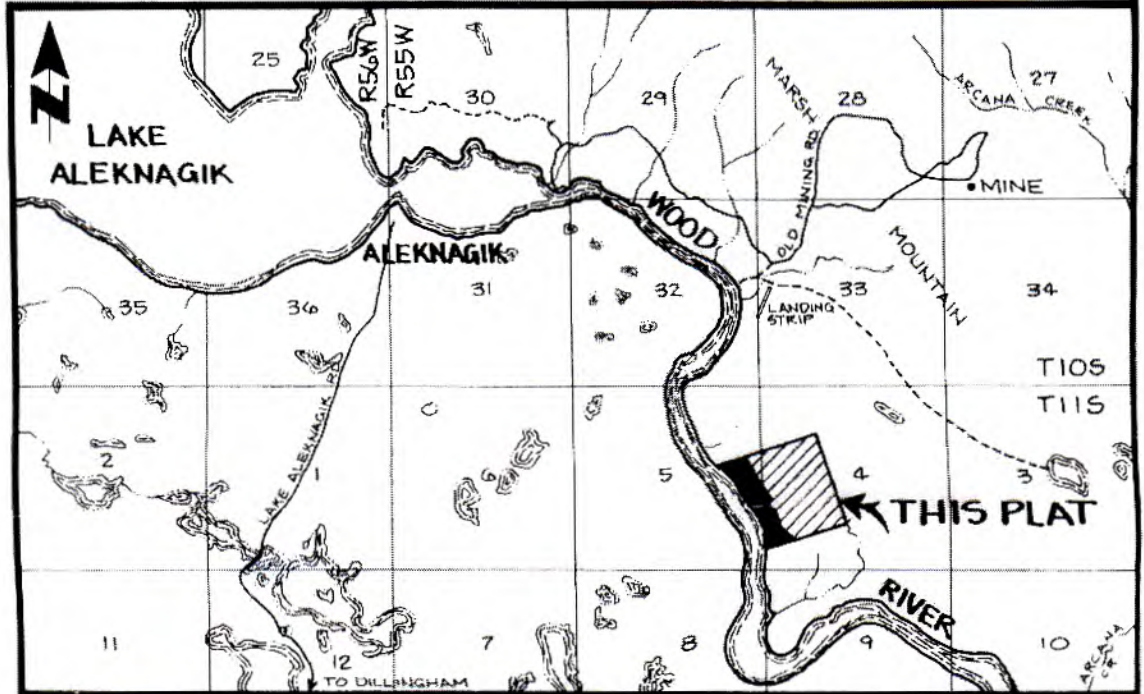

VICINITY MAP SCALE: 1" = 1 MILE DILLINGHAM (B-7), AK. QUAD.

PLAT OF
NUTAN - ATAM ACRES

A SUBDIVISION OF
U.S. SURVEY NO. 8204
 LOCATED WITHIN
 PORTIONS OF UNSURVEYED SECTIONS 4 & 5 T11S R55W, S.M., AK.
 BRISTOL BAY RECORDING DISTRICT
 CONTAINING 159.94 ACRES MORE OR LESS

STAN SEARS & ASSOCIATES
 REGISTERED LAND SURVEYORS
 P.O. BOX 283
 EAGLE RIVER, ALASKA 99577



PREPARED FOR:
MIKE HOSETH
 P.O. BOX 183
 DILLINGHAM, AK
 99576

SCALE: 1" = 100'	DATE: 11-3-86
DRAWN: NY 1-27-87	CHECKED: S.E.S.
GRID: QUAD: DLG - B-7	FIELD BOOK: 121 Pg. 1-146
FILE: HP DLG #5 HOS_8630	WORK ORDER 86-30

, ALASKA

5 LOT 2

THE TRUE
 AS
 TRUE
 ND THEIR

.CRE.

: PLACED

AND

IAL

TAX

CURVE DATA

